

STANDARD MATERIAL OF CONSTRUCTION		
PT No.	PART NAME	MATERIAL
01	Body	ASTM A105
02	Cover	ASTM A105
03	Seat Ring	ASTM A276 GR 410
04	Disc	ASTM A 217 CA15
05	Gasket	SPW +304 Filled with Grafoil
06	Stud Nut	ASTM A193 Gr B7/A 194 Gr 2H
07	Spring	Spring Steel SS 316

MATERIALS OF BODY AND BONNET ALSO AVAILABLE IN F304, F316, F304L, F316L, LF2, F11 AND F22

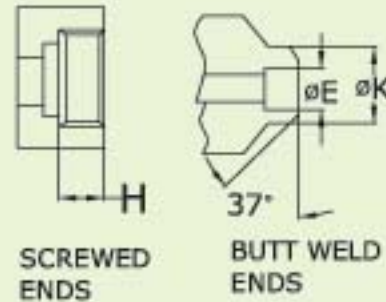

NOTES :

- 1) Dimensions 'A' as per manufacturers Standard.
- 2) Socket weld ends to ANSI B16.11
- 3) Screwed ends to BSP
 - BSPT - BS:21/IS:554
 - NPT - ANSI B 1.20.1
- 4) Butt weld ends to ANSI B16.25
- 5) * For size 40 and 50 mm flow bore is not as per standard.
- 6) All dimensions are in mm.

TEST PRESSURE		BAR
HYBRID STATIC	SHELL	210
	SEAT	152



DESIGN STD : A P I 602 / BS EN ISO 15761
TESTING STD : API 598/BS 6755 PART - I

CLASS	800							
SIZE	8	10	15	20	25	32	40*	50*
A	88	88	88	92	106	128	128	140
B (Approx.)	57	57	57	65	72	109	109	112
ΦD	6.4	6.4	9.0	12.0	17.0	24.0	24.0	30
ΦF	14.2	17.6	21.8	27.2	33.9	42.7	48.8	61.2
G	9.7	9.7	9.7	12.7	12.7	12.7	12.7	15.8
H	10.2	10.4	13.5	14.5	17.3	20.0	21.0	22.0
ΦK	14.1	17.5	23.0	28.0	35.0	44.0	50.0	62.0
Wt. Kgs. Aprox	1.7	1.7	1.62	2.03	2.67	6.0	6.2	8.9

CODE	A105	F304	F316	CA15	CF8	CF8M	410	304	316	F 22
MATRL	A105	A182	A182	A217	A351	A351	A276	A276	A276	A182
SPECN	A105	F304	F316	CA15	CF8	CF8M	410	304	316	F22



ISO 9001:2008
RC91/5900

